

*Fabricated Fittings (non-SABS)



967

| WASTE PIPE | | | | SABS 967 | | |
|---|--------|-----------|------------|-------------|---------------------|---------------|
| | Code | Size (mm) | Length (m) | Type | Wall Thickness (mm) | Weight (kg/m) |
|  | WPE211 | 40 | 2 | Plain Ended | 2.2 - 2.40 | 0.38 |
| | WPE212 | 40 | 4 | Plain Ended | 2.2 - 2.40 | 0.38 |
| | WPE213 | 40 | 6 | Plain Ended | 2.2 - 2.40 | 0.38 |
| | WP211 | 40 | 2 | Plain Ended | 3.2 - 3.35 | 0.58 |
| | WP213 | 40 | 6 | Plain Ended | 3.2 - 3.35 | 0.58 |
| | WPE311 | 50 | 2 | Plain Ended | 2.2 - 2.40 | 0.50 |
| | WPE312 | 50 | 4 | Plain Ended | 2.2 - 2.40 | 0.50 |
| | WPE313 | 50 | 6 | Plain Ended | 2.2 - 2.40 | 0.50 |
| | WP311 | 50 | 2 | Plain Ended | 3.2 - 3.35 | 0.73 |
| | WP313 | 50 | 6 | Plain Ended | 3.2 - 3.35 | 0.73 |

87.5° E-Spec Plain Bend Solvent Weld

WBE40 - 40mm
WBE50 - 50mm



87.5° E-Spec Access Heel Bend Solvent Weld

WBE41 - 40mm
WBE51 - 50mm



135° E-Spec Plain Bend Solvent Weld

WBE42 - 40mm
WBE52 - 50mm



135° E-Spec Access Heel Bend Solvent Weld

WBE43 - 40mm
WBE53 - 50mm



87.5° E-Spec Plain Single Junction Solvent Weld

WTE40 - 40mm
WTE50 - 50mm



87.5° E-Spec Access Heel Single Junction Solvent Weld

WTE41 - 40mm
WTE51 - 50mm



135° E-Spec Plain Single Junction Solvent Weld

WT42 - 40mm
WTE52 - 50mm



135° E-Spec Access Heel Single Junction Solvent Weld

WT43 - 40mm
WTE53 - 50mm



Socket (Solvent)

WS4 - 40mm
WS5 - 50mm



Socket Reducer

WR5 - 50mm x 40mm



Double Socket

WRS5 - 50mm x 40mm



Airvent Cowl

WV52 - 50mm



Stopend - BSP

WA4 - 40mm
WA5 - 50mm



Female Stopend Solvent Weld

WA400 - 40mm
WA500 - 50mm



uPVC Pipe Clip

WH4 - 40mm
WH5 - 50mm



UPVC WASTE PIPES

UPVC WASTE FITTINGS



967

*Fabricated Fittings (non-SABS)

uPVC WASTE FITTINGS & WASTE TRAPS

Male BSP Adaptor

WM04 - 40mm x 1 1/4"
WM4 - 40mm x 1 1/2"
WM051 - 50mm x 1 1/4"
WM05 - 50mm x 1 1/2"
WM5 - 50mm x 2"



Female BSP Adaptor

WF04 - 40mm x 1 1/4"
WF4 - 40mm x 1 1/2"
WF051 - 50mm x 1 1/4"
WF05 - 50mm x 1 1/2"
WF5 - 50mm x 2"



Ratchet PVC Holderbat & Hilti Nail

| | |
|-------------|--------------|
| Packs of 5 | Single unit |
| WHB4 - 40mm | WHB4S - 40mm |
| WHB5 - 50mm | WHB5S - 50mm |



Vent Valve

| | |
|-------------------------|-------------------------|
| One Way (Boxed) | Two Way (Boxed) |
| WAV50 - 50mm | SAV50 - 50mm |
| WAV50BG - 50mm (Bagged) | SAV50BG - 50mm (Bagged) |



White Plain Bath Trap Adaptor & Overflow

ETA28 - 32mm x 40mm
ETB01 - 38mm x 50mm



White Double Sink Combo "T" Piece & Elbow

ETC03 - 38mm x 50mm x 300mm
ETC04 - 38mm x 50mm x 600mm



Pipe Clamp for Waste Traps

ETC25 - 32mm (Standard Clip)
ETC26 - 40mm (Standard Clip)



White Mini 'P' Trap and Standard Connector

ETM21 - 38mm x 50mm
ETM24 - 32mm x 50mm
ETMA21 - 38mm x 50mm
ETMA24 - 32mm x 40mm



White Double Sink 'T' Piece & Elbow

ETC06 - 50mm x 50mm x 50mm
ETC07 - 50mm x 50mm
ETC27 - 50mm x 50mm

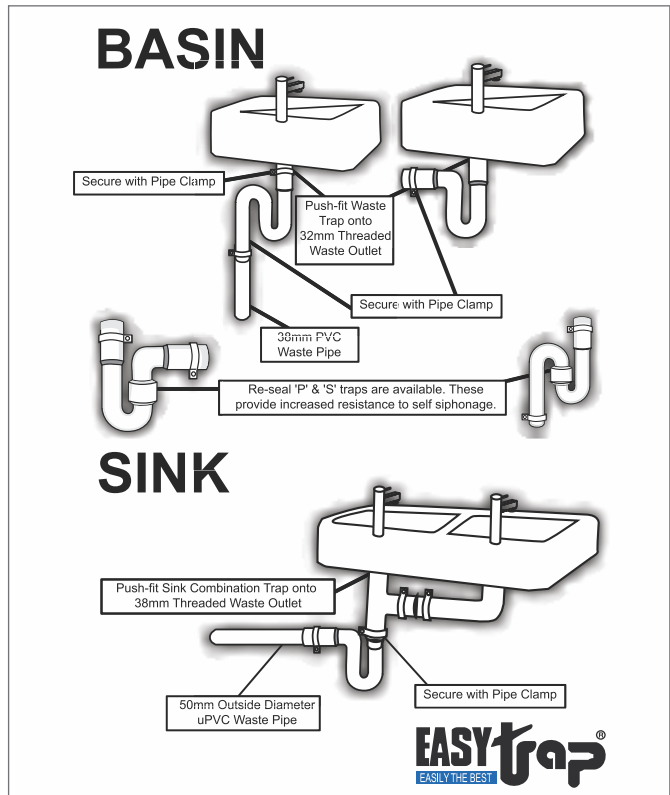
White 'P' Trap (with Re-Seal)

ETP09 - 32mm x 40mm
ETP10 - 38mm x 50mm
ETP11 - 32mm x 50mm
ETPA10 - 38mm x 50mm



White 'S' Trap

ETS15 - 32mm x 40mm
ETS16 - 38mm x 50mm
ETS17 - 32mm x 50mm



Industry Descriptions

| Marley Description (Waste Size) | Alternative Description (PVC Pipe Size) |
|---------------------------------|---|
| 32mm x 40mm | 32mm x 32mm |
| 32mm x 50mm | 32mm x 40mm |
| 38mm x 40mm | 38 mm x 32mm |
| 40mm x 40mm | 40mm x 32mm |